

# USER MANUAL

## General Introduction

This product is a hand-held cleaning equipment, specially designed for long distance cleaning. Two brush rotation direction is opposite, effectively neutralizing rotational force, ensuring product stable. Brush heads contain water outlets ensuring water supply when motor drives brush head to rotate, so as to achieve efficient cleaning effect. Product can be used for cleaning of almost all materials within 9 meters, mainly used for solar panel cleaning.

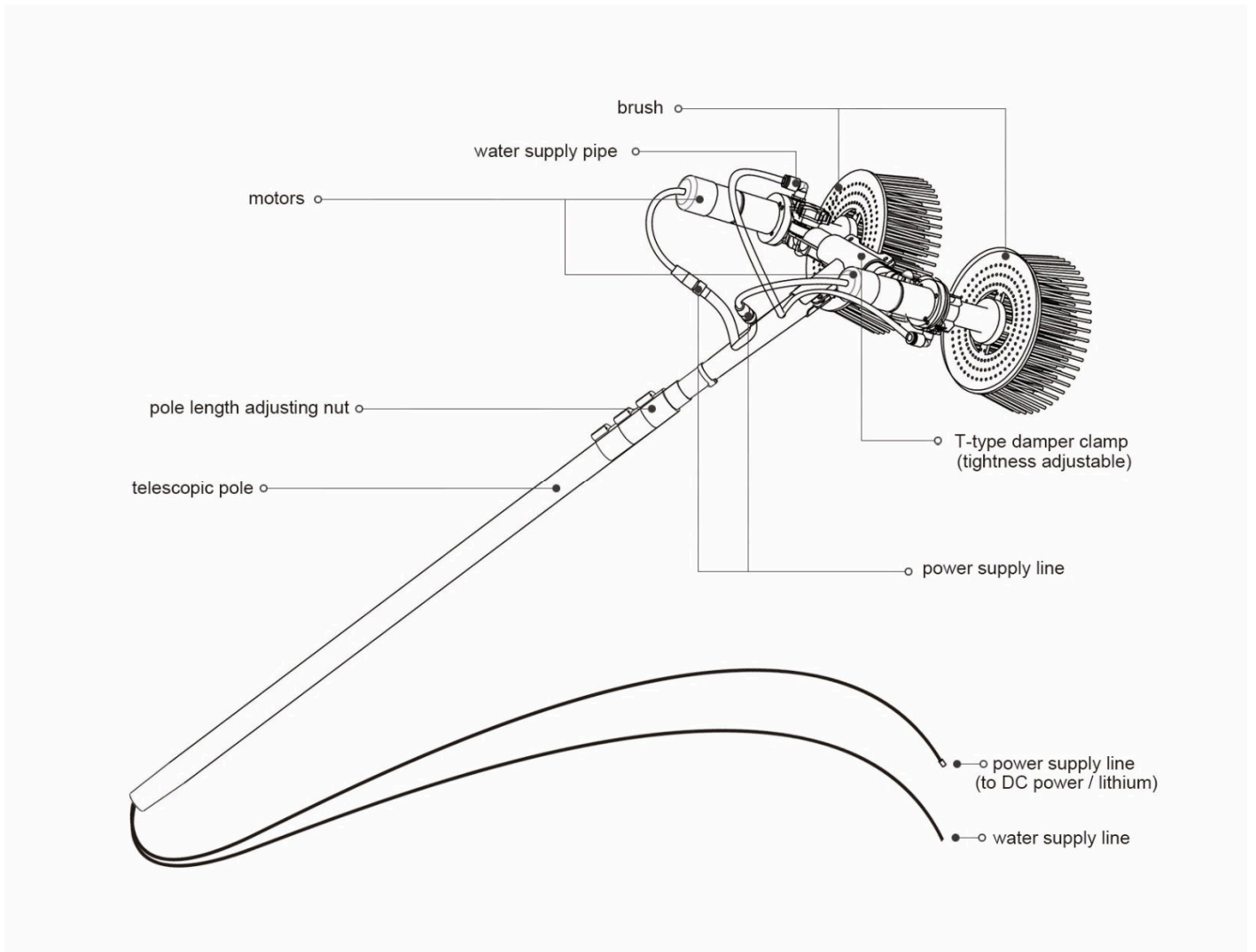

## Installation Instruction

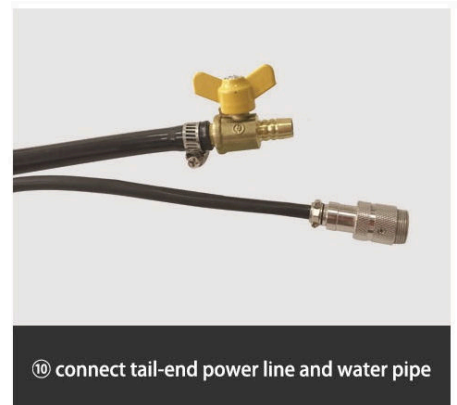
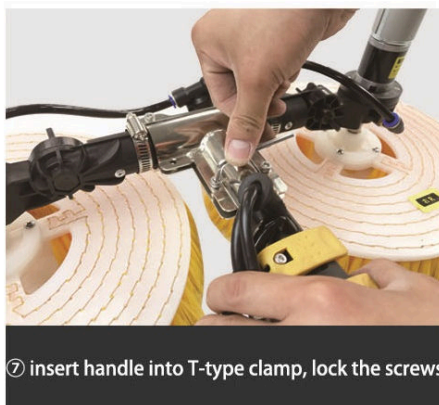
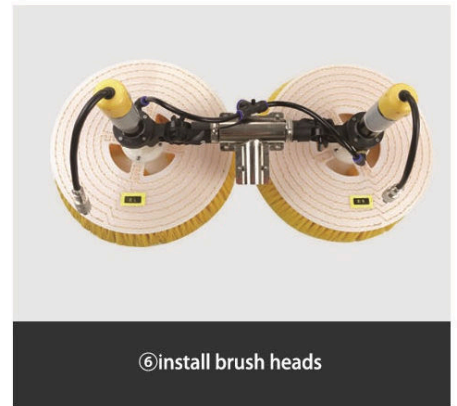
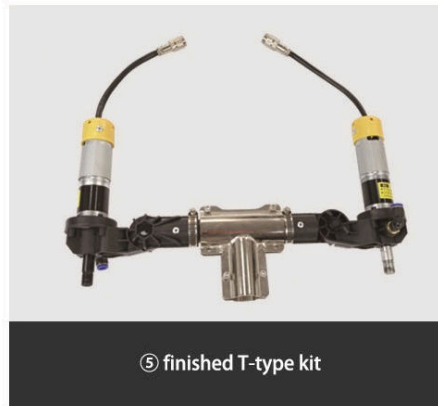
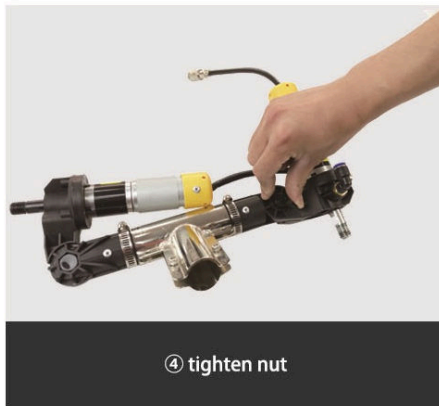
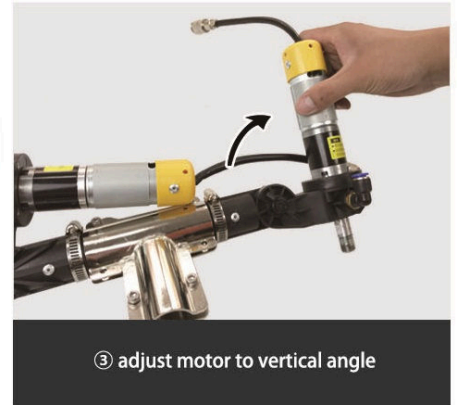
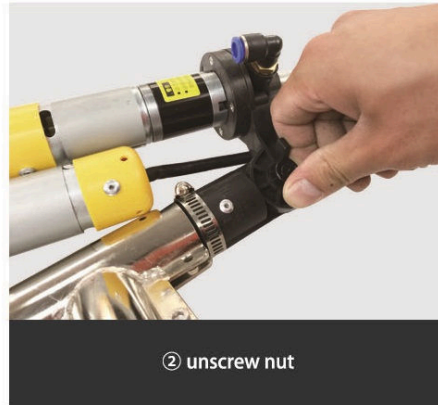

## Use Flow

1. connect tail-end power supply line to power supply system (battery/power converter)
2. connect tail-end water pipe to water supply system
3. adjust water control valve to adjust water flow
4. adjust handle length adjusting nut to adjust handle length

## ***Warning***

1. Motors is not waterproof, do not soak
2. Do not continue to use product when the temperature of motor is too high.  
Water can be poured at the bottom of the motor to cool the gearbox.
3. Power converter and battery charger are not waterproof, do not soak and keep away from water source
4. Do not use inferior socket to avoid the risk of fire
5. If soft wire of power supply is damaged, it must be repaired by professionals

## ***Special Note***

1. do not use this product without water supply system, dry cleaning without water supply would damage the equipment
2. we supply various water supply solutions, you can find suitable solution by contacting us